

Welcome to Loon Call Lake



This document provides you with key information about Loon Call Lake and the region. We hope this makes your time at Loon Call Lake more enjoyable. Please take a few minutes to become familiar with this information and bookmark it so you can come back again and again.

It is your responsibility to know and obey regulations. The information in this document is a guide only. Source material must always be consulted.

Links to reference materials are bold green and work when network connected.



looncalllake.ca



[LooncallLakeCottagersAssociation](#)

Table of Contents

Loon Call Lake	3
History of Loon Call Lake	3
The Cottagers' Association	3
Cottage Roads and Road Associations	3
Lot Identification	4
Life at the Lake	5
Annual Regatta and Corn Roast	5
Message Boards	5
Little Free Library	5
Cottaging	5
Cottage Tips - Being a Good Cottager	5
Visitors and Guests.....	6
Waste Management.....	6
Being Safe, Being Prepared	6
Emergency / Critical Phone Numbers	6
Water Safety.....	7
Boating	7
Recreational Vehicles	7
Fire Safety.....	7
Bear Safety	7
The Lake.....	8
Physical Features of the Lake	8
Water Quality	8
Shoreline Management.....	9
Endangered Species	9
Invasive Species.....	9
Fishing	9
Trails	10
Points of Interest on the Lake	10
Kawartha Highlands Provincial Park.....	11
The Park.....	11
The Landing	11
Reporting Infractions.....	11
Apsley and North Kawartha.....	12
Local Amenities and Services	12
Events In and Around Apsley.....	12
Township By-laws.....	12
Building Permits	12

Loon Call Lake

History of Loon Call Lake

In 2015 the Loon Call Lake Cottagers' Association undertook a major effort to create and publish a Loon Call Lake history that you can see and download from [Loon Call Lake, A Brief History of Cottaging on Loon Call Lake](#). Each new cottage household receives one copy of this book, and can purchase additional copies by contacting the [Loon Call Lake Cottagers' Association President](#) (while quantities last).

The Cottagers' Association

DRAFT Mission Statement

The Loon Call Lake Cottagers' Association (LCLCA) represents the cottage and home owners on Loon Call Lake. Loon Call Lake is situated in the Kawartha Highlands Provincial Park. The membership of the association includes permanent residents and seasonal cottage owners. The LCLCA represents and coordinates the communal interests of its membership. The mandate of LCLCA includes:

- supporting a healthy and sustainable environment
- representing common interest matters to all levels of government including – township, provincial and federal
- facilitating the recreational events which achieve a great sense of community
- promoting effective and ongoing communication with all of our membership and respects the diverse needs of the membership

Selection Process: The Executive is reviewed annually during the executive meeting, and is based on vacated positions and volunteer availability.

You become a member of the Loon Call Lake Cottagers' Association when you purchase a cottage on Loon Call Lake and pay the Association fees. You will be contacted by a member of [the Cottagers' Association Executive](#). You will be:

- asked to pay the Association fees, which are minimal
- invited to the Annual General Meeting where you can participate in discussions and vote
- asked to provide contact information for the Association directory
- added to the distribution list to receive lake and Park updates from the Secretary
- eligible to participate in Association run events including the Regatta and Corn Roast
- part of FOCA - Federation of Ontario Cottagers' Associations- [Access FOCA information here](#)

Contact your Cottagers' Association Executive with any questions or issues. Phone or email from the [Cottagers' Association Executive](#) list.

Calendar of Events:

- Annual Cottagers' Association Meeting: Typically the Saturday before Canada Day
- Annual Road Association Meeting: see Cottage Roads and Road Associations
- Annual Regatta and Corn Roast: Saturday of the long weekend in August [For more info See Annual Regatta and Corn Roast](#)

Cottage Roads and Road Associations

Cottage Roads

- Most cottages are accessible by private roads that have been labelled as Fire Routes (FR).
- Each cottage on the fire route has a number which is essentially its address. It is used by emergency responders and also by your visitors.
- All access roads/fire routes are cottager maintained.
- All access roads/fire routes are connected to Anstruther Lake Road which is maintained by the township.
- Most fire routes are within the Park. Portions of FR55 are not within the Park boundaries. Additionally, the fire routes are typically on Park property although some portions are on private land owned by nearby cottages. Check with your specific Road Association for more details.
- Fire routes are maintained for travel from approximately late April until mid-October.

Travel in the early spring and late fall is not advisable as the road can be easily damaged. Likewise, the roads are not plowed in the winter. Some Road Associations charge additional fees if the road is plowed or if you use the road late in the fall and early in the spring. Check with your Road Association for details.

- Please drive carefully. Sound horn where posted to let your presence be known. Watch for wildlife, pedestrian traffic and other drivers.
- During the winter, parking is not permitted on Fire Routes and Anstruther Lake Road.

Road Associations

- Fire routes are maintained by individual Road Associations. Cottagers pay an annual fee to their specific Road Association for maintenance. To access your cottage, you very possibly will use multiple fire routes. Your annual fee will cover both the road your cottage is on and other fire routes you use.
- Each Road Association has an executive who is voted in at regular intervals, typically two year periods.
- Find your [Road Association President here](#).
- Each Road Association holds an annual meeting. Please contact your Road Association President for details about your annual meeting and to be sure you are included in communications.

For a larger view, right click to open in a new tab, then click on the new tab.

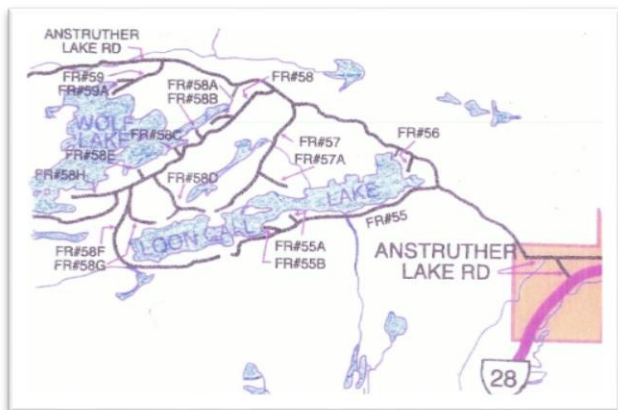

Lot Identification

Cottages are on Fire Routes, and therefore have Fire Route numbers. Cottages are also on the lake, and therefore have lot numbers, too.

For a larger view of either map, right click to open in a new tab, then click on the new tab.

From the Lake: Display your number on your dock or visible from the lake.

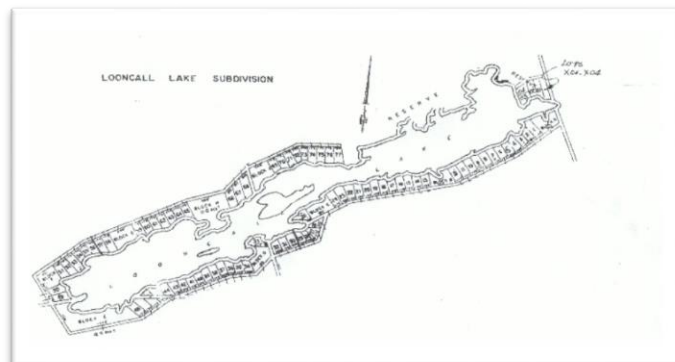

From the Road: Maintain your fire route (civic address) identification number, it is used for emergency purposes.

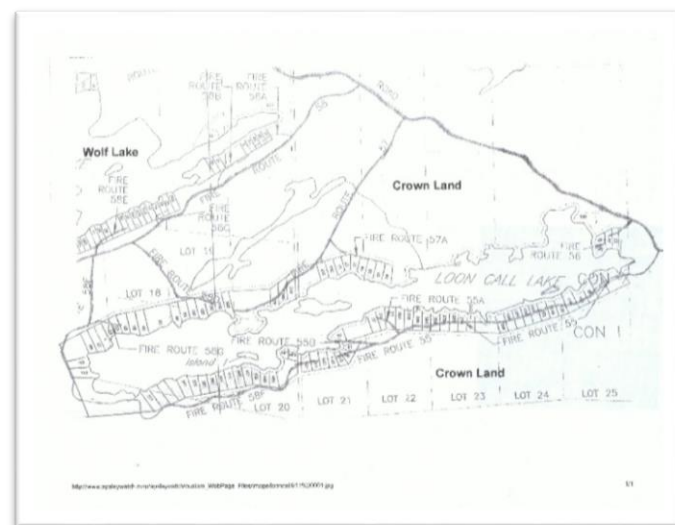

Life at the Lake

Annual Regatta and Corn Roast

Each summer, Loon Call Lake holds a Regatta and Corn Roast on the Saturday of the long weekend in August. Notices will be sent to the email list and signs will be posted on the message boards. Details are also posted on the Loon Call Lake web site and can be reached from here: [Annual Regatta and Corn Roast](#).

Message Boards

Located at various points on our road system are message boards that display news of upcoming events and other general information. They are found in the following locations on the driver's side of the road as you come in: FR 55 (Jessica Drive), FR 57, FR 58D, and FR 58F (at 58G).

Little Free Library



A lending library or Free Little Library is available to anyone visiting the area, not just Loon Call Lake cottagers. It can be found on Fire Route 58F at the intersection of 58F and 58G. It is run on the Take a Book/Leave a Book policy, so take any book and leave any book, or return the book when you have finished reading it.



The Little Free Library's objective is to promote literacy and is part of the [Little Free Library](#) program and is sponsored by [The Rotary Club of Peterborough](#).

Cottaging

Here you will find useful information about cottaging and specifically cottaging on Loon Call Lake.



Cottage Tips - Being a Good Cottager

Please review and adopt these 16 Tips for Cottaging More Lightly – 2019 Draft Revision

1. **Do Not use soap in the lake...ever.** Biodegradable soap only breaks down on land, not in the water. Stock up on greener cleaners. The Park prohibits soaping in the Lake.
2. **Reduce water consumption** and save your septic system. Avoid use of phosphates, bleaches and anti-bacterial soaps, shampoos and cleaning supplies. Do not put grease into your septic tank.
3. **Sniff out a sick septic tank** and have your tank pumped regularly.
4. **Stoop and scoop** after your pooch.
5. **Kick the lawn habit** especially close to the water; allow it to return to natural vegetation; and don't use fertilizers.
6. **Reduce light pollution.**
7. **Keep the water edge natural.** Permits are required from the Park for any dock extensions and major underwater repairs. Ask us or the Park what is exempt.
8. **Keep the Quiet,** sound travels farther over the water; please be sensitive to others. Please respect North Kawartha Township noise curfew of 11:00 pm.
9. **Do Not use lead weights** when fishing and fish only during the fishing season. Don't bring in live baitfish; it is prohibited in the Park.
10. **Boat responsibly,** especially in narrows and near marshes; wakes are a common cause of baby loon deaths. Wakes are also rough on the shoreline, docks and swimmers.
11. **Maintain your boat and motor.** When possible refuel on land where spills can be picked up.
12. **Park rules prohibit ATV use** except for cottage access or during the Hunting Season. This effectively means that ATVs cannot be used on trails or roads between May 24th and September 1, and then only with a valid hunting license.
13. Let your guests know what is acceptable on this environmentally sensitive lake.
14. **Include these and other tips in any rental agreements** that you may make.
15. **Post these tips permanently** in a highly visible place in your cottage. Keep them current.

16. **In doubt about something**...ask your director, or the Lake Steward! We will be glad to arrange for a site visit, suggest an expert or point you to helpful information sources.

[Printable pdf to post](#)

Visitors and Guests

Our aim is to have the lake remain in its present condition or better for future generations. Cottage owners should make renters/visitors aware of the recommended guidelines for cottagers.

Specifically:

- Visitors/renters should minimize noise, follow boating regulations/guidelines and be aware they are sharing the lake with others.
- Pets are to be leashed preferably and barking should be discouraged.
- Remember noise carries across the lake so be careful of what you say and how loud.
- Provide visitors and guests with a copy of the [Cottage Tips - Being a Good Cottager](#).

Waste Management

Waste management services are available to you.

- You will receive a Transfer Station Pass in your spring tax bill
- You must present the pass when using the facilities
- This authorizes you to use the:
 - Anstruther transfer station
 - Haultain transfer station
 - Peterborough disposal services
- Hours of operation are shown on the pass
- Services include:
 - household garbage
 - household recycling
 - organics collection/drop-off
 - household hazardous waste disposal, including paint and gasoline
 - electronics drop off
 - re-use depot
 - leaf and yard waste disposal
 - scrap metal and appliance disposal
 - tire disposal
 - textile drop-off
 - residential and construction disposal
 - spring cleanup drop off
- Curbside pickup on the fire routes is also available on Monday, including Monday holidays between Easter and Thanksgiving,

inclusive. Leave garbage and recyclables no earlier than 7am on the day of pickup.

For more information about North Kawartha waste management services visit northkawartha.ca/en/our-services/garbage-and-recycling.aspx.

If you compost at the cottage, don't put meat, fish, bones, dairy products, grease, or oil in your compost bin, so as not to attract wildlife. Hints for composting in the wilderness can be found at [composting in the wilderness](#).

Being Safe, Being Prepared

Readiness is the key to safety. Please print and post these pages at your cottage in a visible location. Inform any guests, visitors and renters of this information during their orientation.

Emergency / Critical Phone Numbers

Contact	Phone Number
Emergency (OPP, Fire, Forest Fire, Bear, Ambulance)	911
Crime Stoppers	1-800-222-TIPS (1-800-222-8477)
Fire	Non-Emergency: (705) 656-4445
OPP	Non-Emergency: 1-888-310-1122 1-888-310-1133 TTY
Ambulance	1-800-461-3898
Apsley Medical Centre	(705) 656-4281
Hospital for Sick Children	(416) 813-1500
Peterborough Family Health Team - Cottager Walk-In July 4-Aug 25, 2019 Sundays until noon-4pm	(705) 651-4866
Peterborough Regional Health Centre	(705) 743-2121
Poison Info Centre	1-800-268-9017
Quinte Health Centre (QHC) Bancroft	(613) 332-2825

Contact	Phone Number
Township Office	(705) 656-4445
Bear sightings	Non-Emergency: 1-866-514-2327
Hydro One	1-800-434-1235

Take a First Aid / CPR course. It could save a life.

Water Safety

Play safe in the water. For reference material on water safety, go to lifesavingsociety.com/water-safety.aspx.

Boating

You are responsible as a boater to understand and adhere to boating rules and regulations, and to assess boating conditions.

- Canada requires some boats to be licensed. You need to check if this applies to you.
- Canada requires all operators of pleasure craft to show proof of competency.
- Canada has horsepower restrictions for youth. You need to check if this applies to you.
- **Note Loon Call Lake is a very rocky lake.** Not all rocks are marked. The water level can also go up and down over a foot so rocks not visible this week could be a problem next week.
- Be respectful of swimmers, kayakers, canoeists, etc. be aware of [your wake](#) and give them a wide berth.
- Stay as far away as possible from docks so as not to have your wake swamp the dock.
- Respect other cottagers and do not use their docks or shoreline.

Informative links:

- [Transport Canada - Go to the Marine section on Pleasure Craft licences, Operation Competency programs and Safe Boating Guide](#)
- [FOCA Boating Safety tips including OPP Boat Notes](#)
- [Safe Quiet Lakes](#)
- [Boating Ontario](#)
- [Trent Severn Events](#)
- [Pulling a Trailer](#)
- [Boating Info & Tips](#)
- [Boater Exam](#)

Recreational Vehicles

It is your responsibility to understand and follow North Kawartha By-Laws and Ontario Ministry laws, rules and regulations when operating a recreational vehicle, whether riding on your own private property or in public permitted areas. Respect other cottagers and vehicles wherever you travel.

Informative links:

- [ATV and ORV Laws in Ontario](#)
- [ATV and ORV By-laws in North Kawartha](#)
- [Ontario Ministry of Transportation Driver's Handbook which covers operations of ATV, ORV and Snowmobiles under the Off-road Vehicles section](#)

Fire Safety

Fire permits are required for cottagers that wish to have campfires or brush fires. These permits can be obtained online or in person at various locations. All the rules and regulations are on the printed permit. Every once in a while, when there is a severe drought, a fire ban will be issued. The fire ban will be advertised on the radio, with a sign on the Anstruther Lake Road, and on the township website. You can also subscribe to get email notification of fire bans by going to northkawartha.ca/en/our-community/fire-bans.aspx.

Fireworks are banned in the Park.

Fire permits are available online at northkawartha.ca/en/our-services/burn-permit.aspx.

Fire permits are available in person at the following locations.

- Woodview General Store, 6220 Highway 28, Woodview
- Anstruther Marina, FR 63, Anstruther Lake
- Municipal Office, 280 Burleigh Street, Apsley

Use all fire prevention procedures at the cottage that you use at home. E.g. fire detectors, CO detectors, fire extinguishers and a fire safety plan.

Informative Links:

- [Forest Fire Instructions](#)

Bear Safety

We share Loon Call Lake with the bears. It is important that you not invite bears to your cottage. If you encounter a bear, be prepared and know what to do.

- **Do not attract bears:** Do not leave food, food waste, barbecues, scented items, bird feeders outdoors.
- **Prepare:** Take a whistle and bell when walking in cottage country. Review safety measures.
- **If you encounter a black bear:** Stop. Do not panic. Remain calm. Slowly back away keeping the bear in sight. Make noise with whistle or bell.
- If you would like to report a bear problem, call 1-866-514-2327.
- In a life-threatening emergency, call 911.

Informative links with detailed information:

- ontario.ca/page/bear-safety
- ontario.ca/page/keep-bears-away-your-cottage

The Lake

Find out all about the lake that we enjoy so much.

Physical Features of the Lake

Loon Call Lake is a typical Canadian Shield lake with a rugged, granite shoreline and infertile, soft water. It is a head-water lake fed by various ponds around the lake. Loon Call Creek starts at ponds in the area between Wolf Lake and Loon Call Lake, enters on the north side and then Loon Call Creek exits the lake between lots 12 and 13. At the exit, there is a concrete dam (installed in 1972) that controls the level of the lake unless the local beavers downstream have other ideas. Loon Call Creek eventually drains into Eels Creek. There is very little flushing action in the lake with water only flowing over the dam when the water level is high, usually the spring. Summer evaporation can lower the level of the water over 10 cm below the level of the dam.

- Elevation: 329 m
- Surface Area: 86 ha
- Maximum Depth: 16 m
- Mean Depth: 5 m
- Length: 3.2 km
- Width: 0.3 km

Ponds:

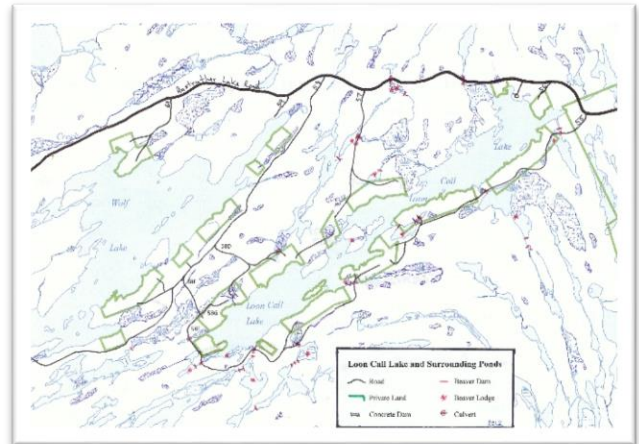

Topography:

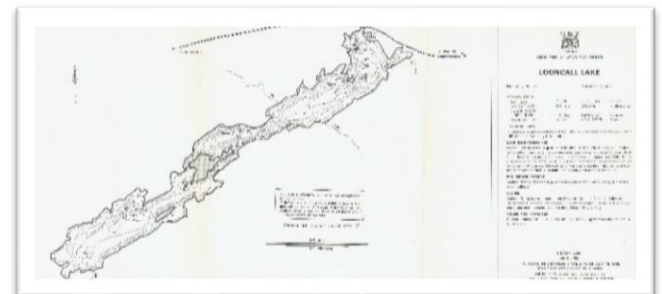

Water Quality

It is of paramount importance for cottagers to maintain the water quality of Loon Call Lake. The 1972 Lake Alert Study concluded that Loon Call Lake was a "sensitive" lake because of its small size, very low water turnover, and the number of cottages (We are over-populated by a factor of 7!). To this date, we have done fairly well. The lake has low nutrient levels and good water clarity. The nutrient limiting factor is phosphorus and our surface levels are in the 6-7 ug/L range which classifies us as an **oligotrophic lake**. Clarity is measured using a Secchi disc and we average in the low to mid 4 m. The good news is that these numbers have not become worse over the decades of testing. We have participated in the Lake Partner Program for decades. Since we have become part of the Park, the Park has partnered with Trent University to test the water in many of the Park lakes to a much greater degree so that the effect of the Park and human use can be monitored.

The total phosphorus and calcium samples are collected every May and then sent to Dorset for testing by the Lake Partner Program. Secchi disk readings are taken throughout the year and mailed in to Dorset, also. Trent University tests the water in

park lakes every two years. [Loon Call Lake Status Report 2018](#).

As a cottager, knowing that we are a sensitive lake, put nothing in the water that you would not drink. Hence, the use of fertilizers near the lake is discouraged.

It is very important that you properly maintain your septic system and maintain a shoreline that buffers the lake from run-off. Our lake is not a sewer, bath tub or laundry tub! We are responsible for the health of the water. The township is increasingly active in inspecting septic systems.

Sites of interest: [Lake Partner Program \(site is not working as of 2020 02 06\)](#)

Shoreline Management

Benefits of a Natural Shoreline: The best kind of shoreline is a natural shoreline with native plants and a vegetative barrier to prevent run-off from the land going straight into the lake. The benefits of a natural shoreline include:

- minimized surface water runoff pollutants flowing into the lake
- increased water absorption by the soil
- improved wildlife habitat
- erosion protection

Visit this link for actions that cottagers can take to assess and improve their shorelines: [Shoreline Protection Workbook 2019](#)

Endangered Species

We have endangered species on Loon Call Lake. It is our duty to protect them!

Endangered species are species that are being threatened by extinction. There are different levels of the term. Depending on the population, a species in trouble can be classified as a:

- species of concern
- species at risk
- threatened species

On Loon Call Lake, some of these species are:

- Blandings turtle
- five-lined skink
- eastern hog-nosed snake

Note: There are various times of the year (e.g. during turtle nesting periods, June to September) that we need to be more aware of wildlife.

See the SARO list at ontario.ca/page/species-risk-ontario

Invasive Species

An invasive species is one that is not native to an area and, because it has no natural controls (disease, predators, consumers, parasites), it can spread to a degree that is deleterious to native populations.

Aquatic examples are:

- zebra mussels (Loon Call Lake may be immune due to our acidity level and calcium level)
- spiny water flea
- eurasian water milfoil
- asian carp
- round goby

Terrestrial (Land) examples are:

- giant hog weed
- dog strangling vine
- emerald ash borer
- gypsy moth
- purple loosestrife
- phragmites

To protect our shared water, make sure any boat that has been in another body of water is thoroughly cleaned before entering our lake. Our public landing is the “door” for unwanted water dwellers.

See invadingspecies.com for more information.

Fishing

Loon Call Lake has a variety of fish suitable for angling.

- Loon Call Lake holds:
 - small mouth bass
 - splake (a speckled and lake trout hybrid, which cannot reproduce), 2100 fingerlings are stocked into the lake every two years on the odd years by the MNR
 - pumpkinseed (a sunfish)
 - yellow perch
 - white sucker
- anyone age 18 to 64 must have a valid fishing licence to fish
- Loon Call Lake is in Zone 15 for fishing regulations

Fishing regulations and licence information can be found at ontario.ca/page/fishing.

Informative Links:

- [Hunting](#)
- [Ontario Fishing Network](#)

Trails

There are three types of trails in the vicinity of Loon Call Lake:

- hiking trails:
 - A two-track trail connecting FR 55 to FR 58F to complete a circle around the lake. It runs from 30 m west of # 324 on FR 55 (at 55A) to 120 m east of #449/459 on 58F. Just west of #401/411 on 58F, there is an indistinct trail across the rock barrens which becomes more distinct as you enter the woods. This trail heads south and has a branch that goes to a trapper's cabin/hunt camp.
 - Another two-track trail, which an old map calls the Lumber Trail, starts 80 m south of #321 on 58F and also heads south. It is not known if these latter two trails meet but the old map (below) shows the Lumber Trail going to Highway 28.
 - Franz Meuller Trail, is a single-tracked trail. It starts 140 m east of #163 on 58F and goes to a promontory overlooking Crab Lake. It provides a great view. On the same old map (below), this trail was called the Miner's Trail and went beyond Crab Lake.
- snowmobile trail:
 - The snowmobile trail (#503) crosses the Anstruther Lake Road 40 m west of FR 57. This trail runs between Wolf and Loon Call Lakes, crosses 58F 240 m in from 58 and then heads west. Snowmobile trails are not good for summer hiking because they often cross wet areas that are frozen over in the winter. To snowmobile on this trail requires a permit. See ofsc.on.ca.
- other trail:
 - In addition to the above mentioned trails, there is one other trail that looks like an abandoned road. It starts 40 m west of the landing (#506) on the north side of the Anstruther Lake Road and heads north. It may become a Park interpretive trail in the future.

Walking in the woods, off road, has inherent danger. The area does have **bears**, people do get lost, and GPS and cell phone reception are not certainties. **Please take all precautions when hiking.**

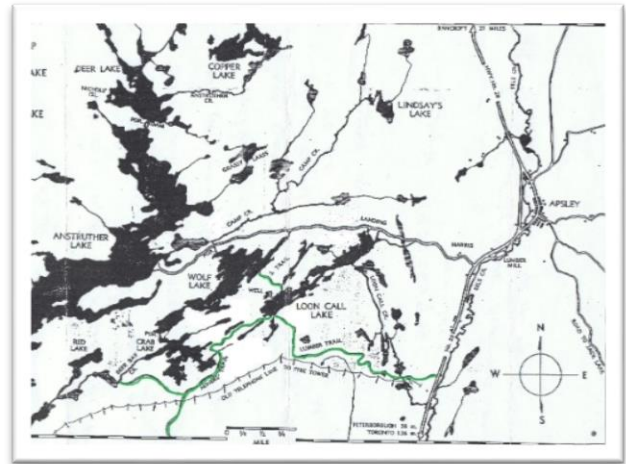

Points of Interest on the Lake

Is there a place on the lake that delights you? Send your Point of Interest to vickie@hartog.ca to be added to the Points of Interest page.



Turtle Log on Fire Route 58F always brightens my day. It can be found just before the point. If a turtle or two are sitting on the log sunning themselves you just know it is a great day. In 2019 a merganser was spotted at Turtle Log.

Your Point of Interest could be here!

Kawartha Highlands Provincial Park

Loon Call Lake is in a provincial park. Learn all about it here.

The Park

Loon Call Lake is located within Kawartha Highlands Signature Site Park (KHSS) also known as Kawartha Highlands Provincial Park, a provincially designated park. Please refer to ontarioparks.com/park/kawarthahighlands to become familiar with the park and its rules. It is your responsibility to know and abide by these rules.

It is important to know that:

- The landing is governed by Park rules.
- Your cottage and many of the fire routes are within the Park.
- Generally, the township controls construction and permits on the land as well as docks. The Park also has oversight on docks. Before commencing any construction, it is best to check with the township (located in Apsley) and the Park (located in Bancroft).
- No camping is allowed on Loon Call Lake. Campsites (by permit) are allowed on nearby lakes.
- There is no parking on Fire Routes or on Anstruther Lake Road during the winter.
- Access permits
 - Cottagers accessing their own property, via a Fire Route, do not require an access permit.
 - Cottagers using the Landing to access their property from May 1 to Thanksgiving require a special access permit and can obtain one free of charge from [The Kawartha Highlands Park office by calling \(613\) 332-3940 x261](#).
 - Cottagers using the landing for a very short period (for example to launch a boat) do not require an access permit.

The Landing

There is a public landing at the north east end of the lake. It can be used to launch boats and is a KHSS park day use area. It has a park sign which explains the cost of day use (for activities such as picnics, fishing). There is no overnight camping at the landing.

Reporting Infractions

Infractions of MNR and/or Kawartha Highlands Park Regulations can be reported as indicated in the table below

Infraction	Reporting
Hunting, Fishing or other MNR violations, illegal camping on park land	Report to the MNR using the MNR TIPS line at 1-877-TIPS-MNR (1-877-847-7667).
Trespassing, illegal camping on private property, or illegal camping on park land (use your discretion, call only for serious or urgent issues)	Report to the OPP at 1-888-310-1122
Bear problems	Report to the MNR at 1-1-866-514- 2327

Apsley and North Kawartha

Loon Call Lake is in North Kawartha, just outside of Apsley. It is a great little town. Find out all about it here.

Local Amenities and Services

The closest town to Loon Call Lake is Apsley. You will find that Apsley has almost everything you need, including:

- Antique Shops
- Appliance Repair
- Automotive, Repairs, Fuel, Towing
- Artisans and Crafts
- Banking (ATM only)
- Barging
- Boat and Motor Services
- Building Services
- Camps - Residential and Day
- Child Care
- Churches
- Cleaning Services
- Community Centre, including public Wi-Fi, fitness and exercise centre, ice skating, etc.
- Community Services
- Construction Contractors
- Cottage Clothing
- Gardening and Property Management
- Gifts and Trinkets
- Golfing
- Groceries, Catering and Food
- Hair Stylists
- Hardware and Building Supplies
- Heating, Cooling, Plumbing and Electrical
- Hunting, Fishing, Bait and Tackle
- Laundry (Paudash - not in Apsley)
- LCBO, Wine, Spirits, and Beer
- [Apsley Library with Wi-Fi](#)
- Newspapers
- Movie Rentals
- Pharmaceuticals
- Post Office
- Elementary Public School
- Restaurants and Bakeries
- Royal Canadian Legion
- Real Estate
- Septic Pumping
- Signs and Graphics
- Spas and Esthetics
- Storage
- Veterinary and Animal Services
- Water Systems and Wells

For current details and contact information you can consult the [North Kawartha Community Directory](#) published by the North Kawartha Library and available at most Apsley businesses. It is an invaluable resource.

If you can't find what you are looking for in Apsley, look north in [Bancroft](#) or south in [Buckhorn](#), [Selwyn and Lakefield](#) or [Peterborough](#).

Events In and Around Apsley

Loon Call Lake:

- Don't miss the [Annual Regatta and Corn Roast.. more here.](#)

Apsley and Surrounding Area Community Events:

- [North Kawartha Special Events including Canada Day Parade, Flea Market. Fire Fly Band and much more](#)
- [Apsley Autumn Studio Tour - Annual - 3rd Saturday & Sunday in September](#)

Further afield, if you are looking for entertainment within easy driving distance, try:

- [Whetung Gallery](#)
- [Trent Severn Events](#)
- [Canoe Museum](#)
- [Curve Lake](#)
- [Petroglyphs](#)
- [Egan Chutes](#)
- [Coe Hill Fair](#)
- [Peterborough Locks](#)
- [Burleigh Falls Locks](#)

Township By-laws

Township of North Kawartha by-law enforcement and compliance, including approvals and compliance, building code, building inspections, property standards, zoning by-laws and zoning maps can be found at northkawartha.ca/en/our-services/by-law-enforcement-and-compliance.aspx.

It is your responsibility to understand and comply with these by-laws.

Building Permits

Everything you need to know about building and building permits in North Kawartha can be found at northkawartha.ca/en/our-services/building-and-property.aspx.